

SPECTROFFER SQS2GFSVA 2 OR 4 LAMP

Page 1 of 2

2' x 4' recessed fluorescent lens frame troffer
Static, 2 or 4-lamp, T5, T5HO or T8

Dimensions

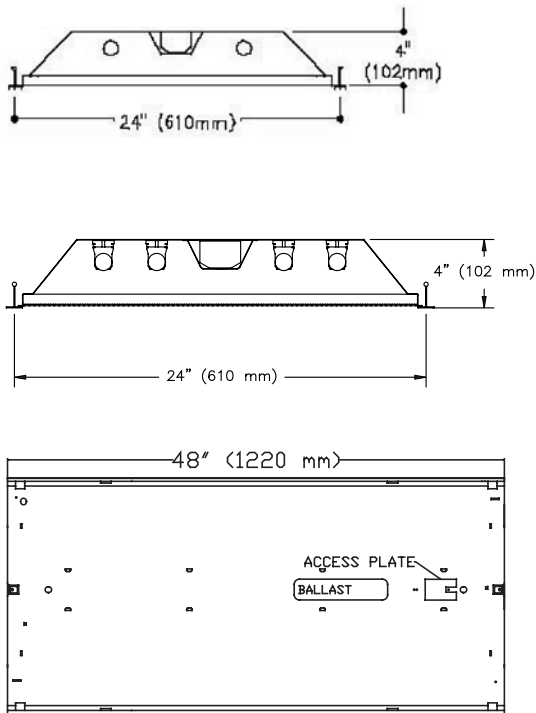

Mounting methods

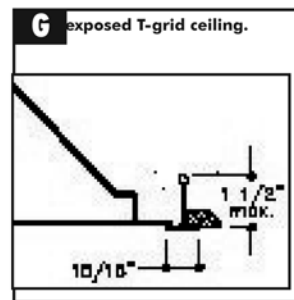

Features

- Efficiency 74.7 %
- Shallow 4" depth.
- One-piece body.
- Flush steel full-size lens frame.
- Cam action latches.
- Twin knockout access plate for easy closed lens frame wiring.
- Built-in Hold-Down clip.
- Luminaire side rails with rolled-over edges for maximum safety.

Options/Accessories

Lense/shielding

VB=Pattern 12 .125" nominal prismatic

VY=Pattern 12 .125" minimum prismatic

KA=Pattern 19 .156" nominal prismatic

AP=1/2 x 1/2 x 1/2 acrylic silver parabolic

SA=1.5 x 1.5 x 1 acrylic silver parabolic

Radio Interference Filter: 120 or 277 volt, 50 or 60 Hz.

One per fixture Suffix: **R**.

Emergency Power Pack: Factory installed emergency power pack includes charger and inverter concealed in fixture channel. Upon loss of AC power, operates one lamp at reduced light. Suffix: **O**.

Drywall Kit : For plaster frame order FK91X4

Job Information

Type:

Job Name:

Cat. No.:

Lamp(s):

Notes:

Lightolier a Genlyte company

www.lightolier.com

631 Airport Road, Fall River, MA 02720 • (508) 679-8131 • Fax (508) 674-4710

We reserve the right to change details of design, materials and finish.

© 2007 Genlyte Group LLC • RF-145-02 REV 2

FLUORESCENT

SPECTROFFER

TEST NO. 8205
CFI 2x4 4" TROFFER LUMINAIRE CAT. NO. SQS2GFSVB232120SO
WITH WHITE PAINTED INTERIOR AND PRISMATIC LENS
TWO F32T8/TL835 32W T8 FLUORESCENT LAMPS. LUMEN RATING = 2950 LMS.
ADVANCE 120V 2-LAMP ELECTRONIC BALLAST NO. REL-2P32-SC
CANADIAN FLUORESCENT INDUSTRIES
CORNWALL, ONTARIO

PHOTOMETRIC FILENAME : C8205.IES

Explanation of Catalog Number. Example: SQS2GFSVA232120SO

Spectroffer
Recessed
fluorescent
shallow design

PERFORMANCE: in an installation of 2 lamp 32W luminaires in a room cavity ratio of 1, with reflectance of 80% ceiling, 50% walls, 20% floor, the C.U. shall not be less than .79. To reduce glare the average luminance at 65 shall not exceed 1369 candelas per square meter. To control veiling reflections, luminaire output in the 30° -90° zone shall be not less than 67%.

FINISH: Chassis exterior—black baked polyester enamel. Cavity—white baked polyester enamel minimum 86% reflectance. Phosphate undercoating.

ELECTRICAL: Rapid start HPF, thermally protected class "P" ballast C.B.M. certified by E.T.L. If K.O. is within 3" of ballast, use wire suitable for at least 90°

LABELS: Listed by CSA.

Type:

www.lightolier.com

We reserve the right to change details of design, materials and finish.

© 2007 Genlyte Group LLC • RF-145-02 REV 2

CFI FLUORESCENT